

1

VISIONCUT 106 LE PE LER	3.00 m	9.84 ft
-----------------------------	--------	---------

2

VISIONCUT 106 LE PE	7.18 m	23.56 ft*
VISIONCUT LER	9.07 m	29.76 ft*

3

VISIONCUT 106 LE PE	5.83 m	19.13 ft*
VISIONCUT LER	6.60 m	21.65 ft*

*Values may vary according to the configuration.

VISIONCUT 106
LE | PE | LER

- > At a glance
- > Packaging market
- > Benefits and features
 - > 1 – 3
 - > 4 – 6
 - > 7 – 9
- > Specifications
 - > Measurements
 - > Configurations
 - > Technical information
- > Related products
 - > 1 – 3
 - > 4 – 6
- > Services
 - > General services
 - > BOBST Connect
 - > Tooling
 - > TooLink
 - > Digital Inspection Table

 **Print responsibly**
Data is not binding.
Non-contractual pictures.
The manufacturer reserves
the right to make
modifications without notice.
© BOBST SA 2019
BUSF-VCT106LE/PE/
LER-EN-0722

VISIONCUT 106 LE | PE

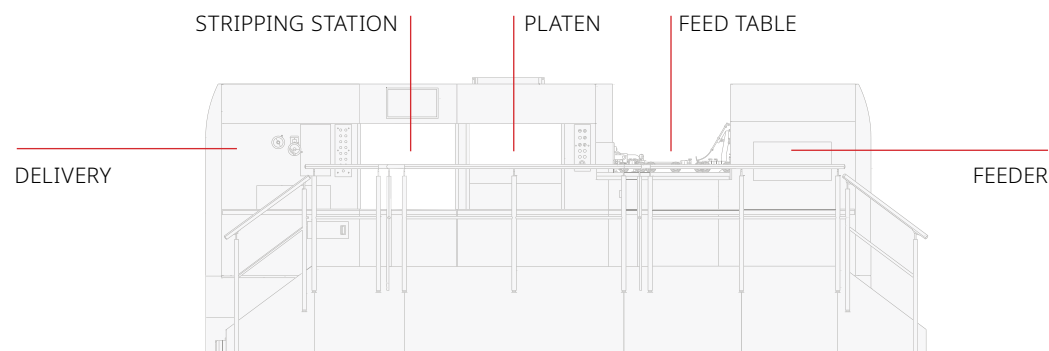

VISIONCUT 106 LER

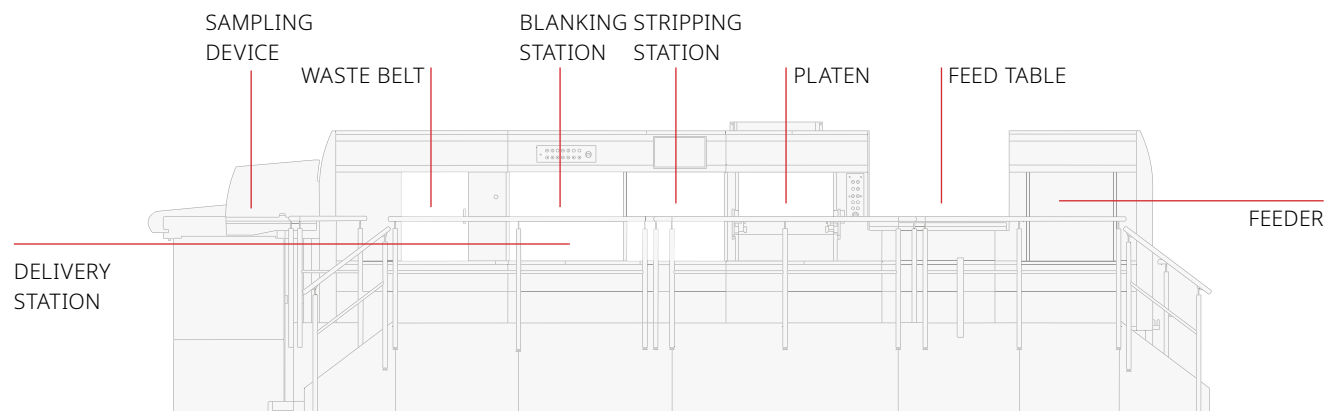

L LATERAL REGISTER
E Stripping
R Blanking
P POWER REGISTER

VISIONCUT 106 LE | PE | LER

- > At a glance
- > Packaging market
- > Benefits and features
 - > 1 – 3
 - > 4 – 6
 - > 7 – 9
- > Specifications
 - > Measurements
 - > Configurations
 - > Technical information
- > Related products
 - > 1 – 3
 - > 4 – 6
- > Services
 - > General services
 - > BOBST Connect
 - > Tooling
 - > TooLink
 - > Digital Inspection Table

Print responsibly
 Data is not binding.
 Non-contractual pictures.
 The manufacturer reserves
 the right to make
 modifications without notice.
 © BOBST SA 2019
 BUSF-VCT106LE/PE/
 LER-EN-0722

Convertible stock**VISIONCUT 106 LE | PE | LER**

Paper, min.	70 g/m ²	.004 in
Carton or solid board, up to	2,000 g/m ²	.060 in
Corrugated board, up to	4 mm	.160 in

Capability

Sheet size, max.	1,060 x 760 mm	41.73 x 29.92 in
Sheet size, min.	400 x 350 mm	15.74 x 13.77 in
Production speed, up to	8,000 s/h	8,000 s/h
with speed upgrade option*	9,000 s/h	9,000 s/h
Cutting force, up to	2.6 MN	286 US ton

*Speed plus option available only on LE | PE

Die-cutting

With gripper margin, max.	1,060 x 746 mm	41.73 x 29.37 in
Embossing size, max.	1,060 x 730 mm	41.73 x 28.74 in
Gripper margin	9 - 17 mm	.35 - .67 in
Height of cutting rules	23.8 mm	.94 in

Pile height

Feeder, max.	1,400 1,400 1,820 mm	55 55 71 in
Feeder, max. with non-stop, manual	1,100 1,100 1,520 mm	43 43 60 in
Delivery, max.	1,235 1,235 1,550 mm	48 48 61 in

Pile height - Elevated machine**VISIONCUT 106 LE | PE**

Feeder, max.	1,820 mm	72 in
Feeder, max. with non-stop, manual	1,520 mm	60 in
Delivery, max.	1,655 mm	65 in

**VISIONCUT 106
LE | PE | LER**

- > At a glance
- > Packaging market
- > Benefits and features
 - > 1 - 3
 - > 4 - 6
 - > 7 - 9
- > Specifications
 - > Measurements
 - > Configurations
 - > Technical information
- > Related products
 - > 1 - 3
 - > 4 - 6
- > Services
 - > General services
 - > BOBST Connect
 - > Tooling
 - > TooLink
 - > Digital Inspection Table

**REQUEST
CONSULTING**

 Print responsibly
 Data is not binding.
 Non-contractual pictures.
 The manufacturer reserves
 the right to make
 modifications without notice.
 © BOBST SA 2019
 BUSF-VCT106LE/PE/
 LER-EN-0722

HEIDELBERG LETTERPRESS MACHINE SPECIFICATION

Table of most important adjustments for various stock

This table can only give the approximate adjustment. Maximum production speed on each run depends upon paper, size, and ink. The experienced printer will, therefore, make minor adjustments as the run proceeds until he has obtained the highest possible running speed.

Adjustments	Air-Mail and Thin Paper	Medium-Weight Bond	Cardboard
Distance of Feed Pile from Suckers	Top sheet approx. $\frac{1}{2}$ " (12 mm) from suckers	Top sheet approx. $\frac{1}{4}$ " (6 mm) from suckers	Top sheet directly under suckers
Sucker Bar Tilt	Usually use plenty of tilt, but there are thin papers which can be run better without tilt	Tilt indicator in centre position	No tilt. Indicator on "Cardboard"
Paper Feed	Paper feed indicator on or near "Thin Paper" setting	Indicator in centre position	Indicator on or near "Cardboard" setting
Paper Separation	Place red side for thin paper on suckers 90° separator springs as far out as possible	45° separator springs as far out as possible	Place rubber discs on suckers. Retract front separator springs, instead place side separator springs extending slightly over edge of pile
Feed Air Blast	Reduce air blast. Blower in top position	Medium to full air blast till sheet flutters. Blower in middle position	Full air blast. Blower in lowest position
Delivery Air Blast (Air blast motor, the air flow of which is controlling the sheet when transported to delivery pile)	Reduce air blast more or less all the way, depending upon paper size and printing speed	Medium to full air blast	Little air blast necessary.
Delivery Air Blast directly above the delivery pile	Reduce air blast depending upon paper size and printing speed	Medium to full air blast so that the sheet falls quickly down on the pile	Full air blast
Cylinder Brush	Engage lightly in 1st position	Brush engaged in centre position during the first run. During the following runs engage brush as required	Brush fully engaged

HEIDELBERG LETTERPRESS MACHINE SPECIFICATION

Specifications for the Original Heidelberg Cylinder

		22 ¹ / ₂ x 30 ¹ / ₄ "	22 ¹ / ₂ x 32 ¹ / ₄ "
Maximum sheet size		22 ¹ / ₂ x 30 ¹ / ₄ "	22 ¹ / ₂ x 32 ¹ / ₄ "
Minimum sheet size		11 ⁷ / ₁₆ x 15 ³ / ₄ "	11 ⁷ / ₁₆ x 15 ³ / ₄ "
Largest half-sheet two up		14 ³ / ₈ x 22 ¹ / ₂ "	15 ⁹ / ₁₆ x 22 ¹ / ₂ "
Smallest half-sheet two up		8 ¹ / ₄ x 11 ¹ / ₁₆ "	8 ¹ / ₄ x 11 ¹ / ₁₆ "
Inside measurement			
Standard chase		22 ¹ / ₁₆ x 28 ³ / ₈ "	22 ¹ / ₁₆ x 30 ³ / ₈ "
Skeleton chase		22 ¹ / ₁₆ x 29 ¹ / ₈ "	22 ¹ / ₁₆ x 31 ³ / ₁₆ "
Maximum forme			
standard chase		21 ¹ / ₄ x 28 ³ / ₈ "	21 ¹ / ₄ x 30 ³ / ₈ "
skeleton chase		21 ¹ / ₄ x 29 ¹ / ₈ "	21 ¹ / ₄ x 31 ³ / ₁₆ "
between bearers		21 ¹ / ₄ x 30"	21 ¹ / ₄ x 32 ¹ / ₄ "
Gripper margin adjustable between		5 ⁵ / ₁₆ and 3 ³ / ₈ "	5 ⁵ / ₁₆ and 3 ³ / ₈ "
Length of forme from pitch line to leave			
with 3 ³ / ₈ " (10 mm) gripper margin		21 ⁵ / ₈ "	21 ⁵ / ₈ "
Maximum speed		4600 i.p.h.	4600 i.p.h.
Power requirements		HP 8,3	HP 8,3
Net weight	approx.	11.700 lbs	12.125 lbs
Gross weight packed	approx.	14.600 lbs	15.000 lbs
Overall length		11'6"	11'6"
Overall width including motor		6'7"	6'7"
Height to top of feeder		5'1"	5'1"
Bowl rails		4	4
Number of forme rollers		4	4
Packing thickness	approx.	.047"	.047"

HEIDELBERG LETTERPRESS MACHINE SPECIFICATION

Floor plan
for the Original Heidelberg Cylinder $22\frac{1}{2} \times 30\frac{1}{4}$ " / $22\frac{1}{2} \times 32\frac{1}{4}$ "

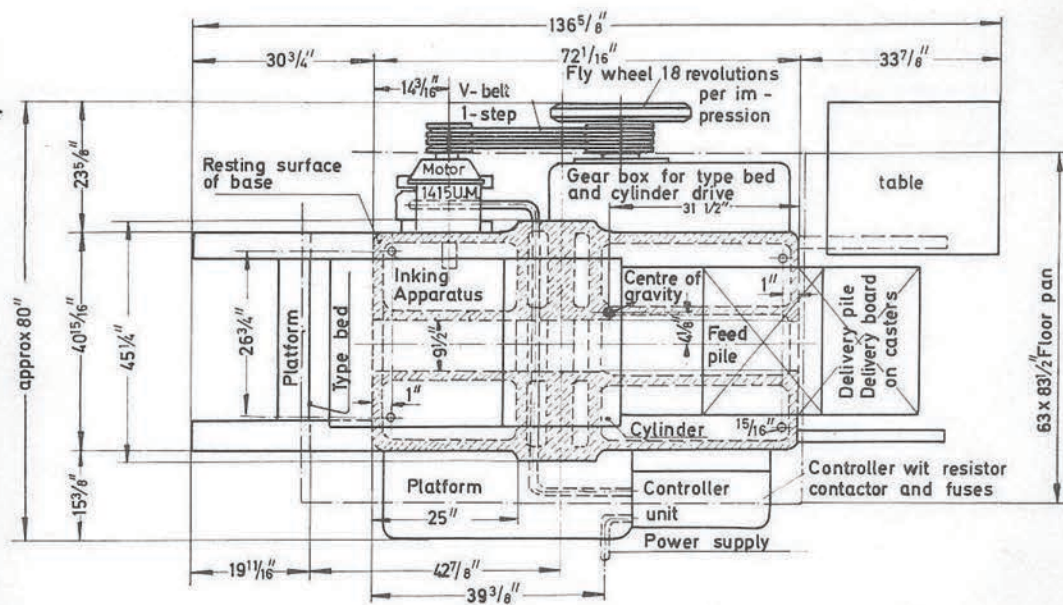
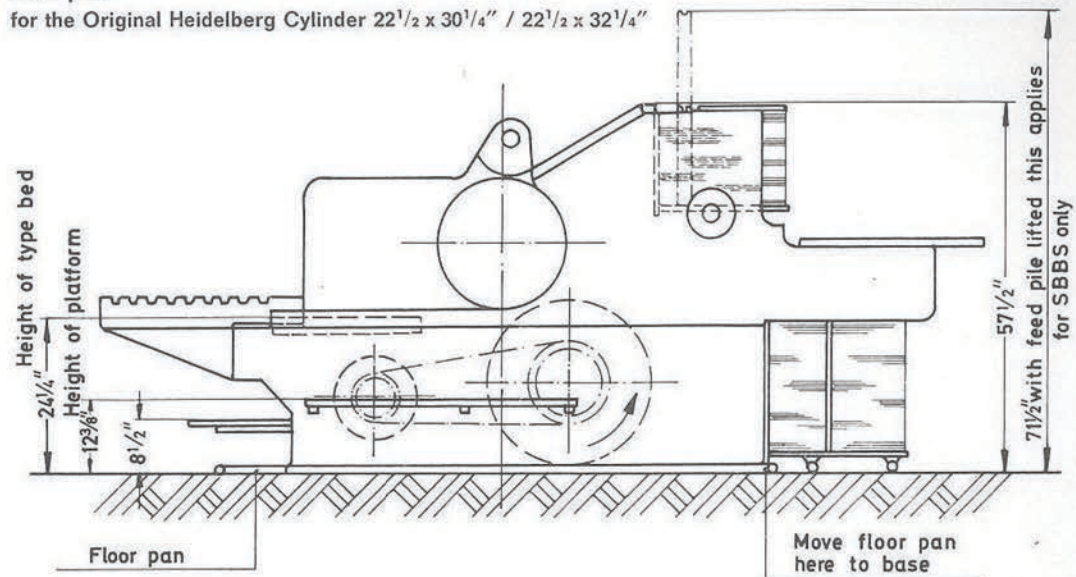

Minimum distance on all 4 sides = $25\frac{5}{8}$ " (650 mm)
Floor contact surface = 22 sqft. (2,1 m²)



The Prinect Easy Control spectrophotometric color measurement system integrated in the control station ensures economical production with maximum color integrity.



Sheet brakes can be positioned as desired in the delivery, enabling precise pile formation without marks.



Efficient drying thanks to the combination of IR lamps and hot air in a single module.

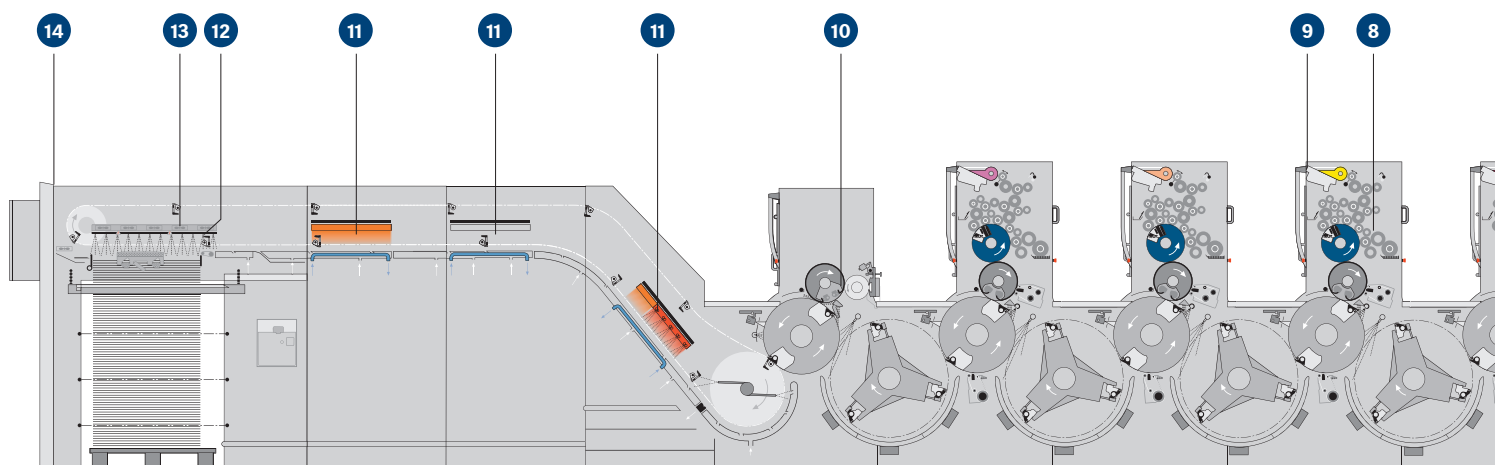

Speedmaster CD 102-6+L with two extension modules and DryStar Combination Carton.

The machine shown is a sample configuration. Some of the equipment features mentioned are optional.

1 Nonstop system

- The features on the feeder and delivery enable pile changes on the fly.

2 Feeder

- With preset air settings and material-dependent speed compensation, the Preset Plus feeder separates a huge variety of substrates with great precision.

3 Sheet alignment

- Precise sheet alignment is ensured by accurate, remote setting of front lays, automated sheet arrival control and sheet slowdown feature.

4 Monitoring

- Sheet monitoring by sensors and four self-calibrating double-sheet detectors support continuous production.

5 Printing unit

- Reduced maintenance thanks to cylinder surfaces with a high-quality finish, and special gripper systems. Central remote register adjustment shortens setup times.

6 AutoPlate

- The semi-automatic plate changer works quickly and precisely at the touch of a button, and saves valuable makeready time.

7 AirTransfer system

- The AirTransfer system with Venturi nozzles guarantees contact-free, stable sheet transport over the entire printed stock range of substrates 0.03 to 1 mm (0.0012 in – 0.039 in) thick.

8 Inking unit and film dampening system

- The speed-compensated Alcolor film dampening unit with Vario function ensures a stable ink-water balance and prevents hickeys. The inking unit with high storage capacity promises stable coloring over the entire production run.

9 Ink fountain

- The calibration-free ink fountain with 500 increments per color zone achieves superior quality and can be cleaned quickly and easily thanks to an ink fountain liner.

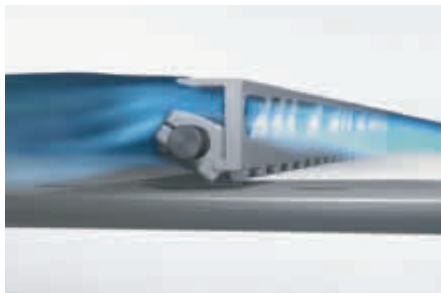

The aerodynamic gripper bar enables high speeds thanks to optimized flow conditions.

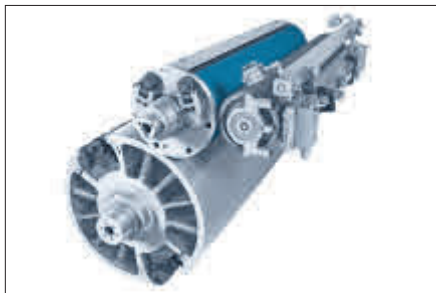

The coating unit with chamber blade system ensures a homogeneous coating application.



Super-fast ink changes thanks to ink fountain liner.

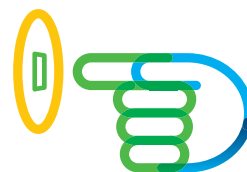
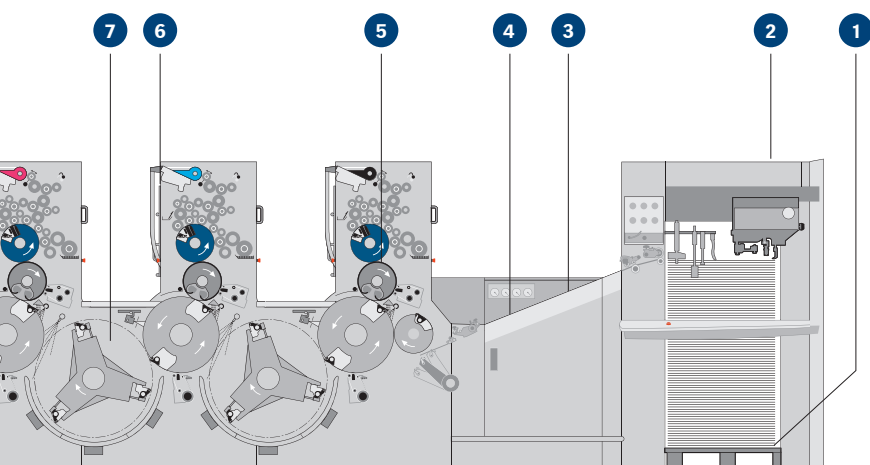

Push to Stop.
The key to the
Smart Print Shop.

10 Coating unit

- A chamber blade system in the coating unit ensures homogeneous coating application. Combination clamps enable rapid changes between spot and full area coating.

11 Dryer

- Various dryer systems are available, depending on the equipment of the Speedmaster CD 102. Short distances between dryer and sheet optimize energy consumption.

12 Sheet brake

- The sheet brakes can be positioned as desired, preventing marks on the sheet. They ensure rapid work-and-turn and short throughput times.

13 StaticStar

- Antistatic equipment minimizes electrostatic charging of sheets and ensures uniform sheet separation and stable sheet travel, even with static materials.

14 Delivery

- The Preset Plus delivery with intuitive navigation via touch-display and jogwheel ensures precise pile formation. It enables problem-free second print runs and postpress.

+ Prinect Press Center XL 3

- The controlstation Prinect Press Center XL 3 with the intuitive Intellistart 3 operator navigation system for a fast, process-oriented setup and high usability.

+ Maintenance

- Fully automated central lubrication of the entire machine on the drive and operator sides considerably cuts maintenance times.

→ You can find more about the details of your Speedmaster here: heidelberg.com/en/cd102

Leader in the printing process.

9 clear benefits.

Makeready



1 hour

washup time per day saved thanks to the world's fastest washup systems. Intelligent, parallel washup programs cut two minutes off each washup cycle compared with the industry standard.

5 minutes

saving per ink change and printing unit – instead of five or even ten minutes of cleaning, each ink fountain is cleaned in just one or two minutes.

60 Minuten faster in postpress thanks to freely positioned sheet brakes and Venturi sheet guidance for faster work-and-turn.

User friendliness

300

wasted sheets and **10 minutes saved** when changing to difficult substrates thanks to material-dependent, stored preset air settings. Flexibility without loss of productivity.

1,000 sheets/h higher net production thanks to sheet arrival control and monitoring, ensuring stable, uninterrupted production.

OEE

Improved overall equipment efficiency – navigated printing reduces process and operator-dependent downtimes.

Productivity

70 %

fewer operating steps per job change thanks to the patented Intellistart.



Just

2 clicks

to select and release job for printing.

Roller settings are checked in just **5 minutes** and 20 minutes are saved per adjustment cycle with the **Roller Check Assistant** software.

Heidelberger Druckmaschinen AG

Kurfuersten-Anlage 52 – 60

69115 Heidelberg

Germany

Phone +49 6221 92-00

Fax +49 6221 92-6999

heidelberg.com

Publishing Information

Printed in: 03/20

Photographs: Heidelberger Druckmaschinen AG

Platemaking: Suprasetter

Printing: Speedmaster

Finishing: Stahlfolder

Paper: Magno Satin Sappi Europe

Consumables: Saphira

Fonts: Heidelberg Antiqua MI, Heidelberg Gothic MI

Printed in Germany

Trademarks

Heidelberg, the Heidelberg logotype and Alcolor, Axis Control, DryStar, Intellistart, Prinect, Prinect Press Center, Saphira, Speedmaster, Stahlfolder, StaticStar and Suprasetter are registered trademarks of Heidelberger Druckmaschinen AG in the U.S. and other countries. All other trademarks are property of their respective owners.

For details on the emissions of the Speedmaster CD 102, please visit us at heidelberg.com/emissiondetails

Subject to technical modifications and other changes.

Liability for contents

The contents of this brochure have been prepared with great care. No warranty or liability is accepted for the correctness, completeness, or accuracy of the information. There is no guarantee that the customer will be able to achieve the values and numbers (e.g. relating to the function and performance of the machine and the software) specified in the brochure. The information provided is based on ideal conditions and proper use of the machine and the software. Achieving these values and numbers depends on a variety of factors and circumstances that are outside the control of Heidelberg (e.g. machine settings, technical conditions, ambient conditions, raw materials and supplies used, consumables used, standard of care and maintenance of the machine, expertise of the operator, meeting the respective system requirements, etc.). They therefore constitute neither characteristics of the machine or the software nor a guarantee. This brochure does not constitute a contractual offer and is solely for the purpose of providing (non-binding) information.



USTAR-102C

Converting
Tymi Group

www.tymimachinery.com

- Manufacturing :
 - UV Coating Machine
 - UV Laminating
 - Coating Machine
 - Plate Laminating
 - Screen and Printer Drum
 - Laminator & Coextruder
 - Paper Printer Coater
- OEM & Reprocess related machine
 - Automatic Paper Drum
 - Paper Drum Coating Machine
 - Printing Machine
 - Ink Printer Machine



Ustar-102C Video Link

<https://www.youtube.com/watch?v=z4z2u9RdyeQ&index=1&list=PLFVGxwP-Jq8UefcmkhZBpzza3ptdPZmpo>

(1). High Speed UV Spot Coating Machine (Conveyor Type)

Model: USTAR-102C

1 Set

Max. sheet	: 740 × 1030 mm
Min. sheet	: 340 × 406 mm
Max. coating area	: 720 × 1020 mm
Sheet thickness	: 80 ~ 500 gsm
Machine speed	: UP to 8800 sheet/hour (Depending on sheet weight size and quality)
Power required	: 58.1kw (UV) / 82.1 kw (water base)
Dimension (L × W × H)	: 13353 × 3150 × 1865 mm
Weight	: 13750 kg

YouTube: www.youtube.com/user/TymiMachinery

Technical Data

Measuring up!

Technical Data		POLAR 56	POLAR 66	POLAR 80
Cutting width	mm	560	670	800
Feed depth (C)	mm	560	670	800
Feeding height, max. (without false clamp plate)	mm	80	80	100
Length of front table (D)	mm	670	670	670
Table height	mm	900	900	900
Clamping pressure, min.	daN	180	180	180
Clamping pressure, max.	daN	1,200	1,500	2,700
Backgauge speed, return stroke (0 - ...)	mm/sec	70	70	130
Knife speed	Cycles/min.	20	20	20
Thickness of knife	mm	9.70	9.70	11.75
Grinding reserve (HSS18 knife) max.	mm	22	22	25
Smallest cut, manual, without false clamp plate	mm	-	-	15
Smallest cut, automatic, without false clamp plate	mm	15	15	15
Smallest cut, automatic, with false clamp plate	mm	50	50	50
Noise emission (EN 13023)	dB(A)	76.5	76.5	76.5
Installation data				
Width (B)	mm	1,150	1,250	1,550
Depth (A)	mm	1,670	1,825	1,970
Frame height (E)	mm	1,500	1,500	1,500
Weight, total net	kg	575	675	900
Static floor load	daN/m ²	330	330	626
Dynamic surcharge	%	20	20	20
Electr. power draw (apparent power)	kVA	2.2	2.4	4
Thermal output	BTU/h	7,135	7,784	12,973

Subject to technical alterations

Available accessories:

- Cutting sticks (Set of 10 items)
- HSS-knives
- Carbide-tipped knives
- Knocking block
- EasySlide

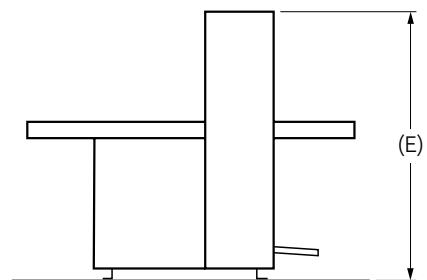
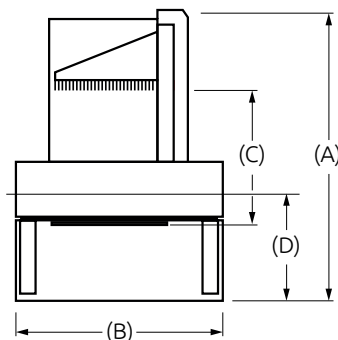

POLAR One-Knife Trimmer

POLAR One-Knife Trimmer BC-330

The robust, networkable POLAR one-knife trimmer is the machine for automatically cutting perfect-bound or saddle-stitched products. In contrast to a three-knife trimmer, it only has one knife. The product is put into the cutting position by a gripper.

The cut is hydraulic, which enables the time the knife spends in the bottom dead center to be adapted to the material. The robust cutting unit guarantees a precise cut that is gentle on the material. The applied pressure can be infinitely adjusted to every material to be cut within a large adjustment range.

To increase performance, several products, stacked on top of each other, can be cut simultaneously. The container for waste can be accessed from the outside.

The machine is operated using an ergonomically positioned 18.5" touchscreen display. Recurring cut sizes can be stored

and adapted at any time. Integrated in the digital workflow, the cutting data is transferred directly. The machine can be equipped with a bar-code reader to automatically launch the cutting program. This reduces the set-up time to practically zero.

The highlights

- Integration in the digital workflow
- Format can be varied from product to product
- Simple knife exchange with automatic shut-off in bottom dead center and fine adjustment from the front

Technical Data		
Performance (single multiple block)	Books/h	240 550
Inner book untrimmed min. max.	mm	120 x 152 305 x 330
Inner book trimmed min. max.	mm	105 x 148 297 x 325
Head trim min. max.	mm	2 100
Front trim min. max.	mm	2 100
Tail trim min. max.	mm	2 100
Book thickness min. max.	mm	5 51
Dimensions (W x D x H)	mm	1,780 x 1,530 x 1,580





Model: XS-650/850/1100

Name: Automatic Folder Gluer

4. All functional components of this machine are modularized, which is convenient and quick to combine, and it saves time for changing the box-making products and debugging. Beginners are easy to master the technology, easy to understand and learn.

5. The left and right bottom glue cylinders and glue spraying system are matched with the unique design of the bottom locking product.

6. Using photoelectric counting, total or quantitative counting is possible, and it is equipped with kick board mark and water spray mark to distinguish the quantity.

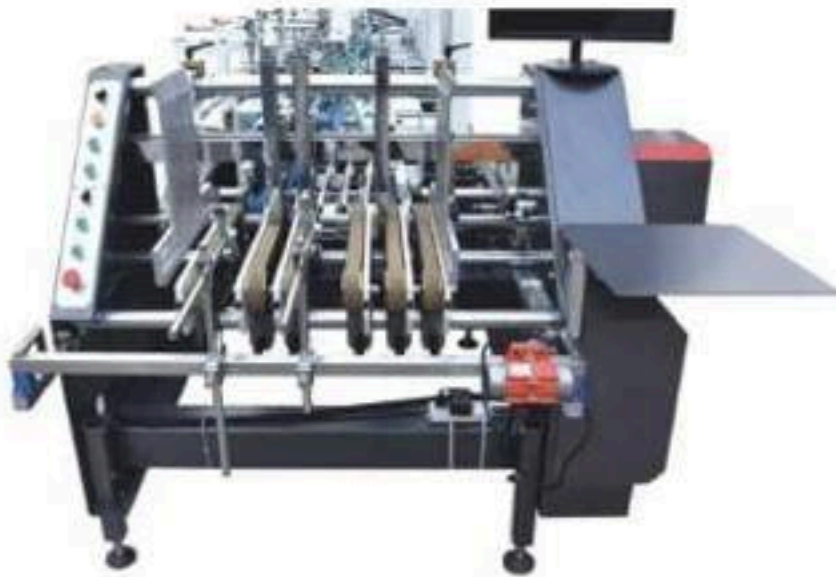

Feeder

- Set up quickly and rapidly
- Variable speed independent servo motor
- Adjustable on the run
- Easy repeatability
- Light maintenance
- Feeds most types of materials
- Handles most box styles
- Feeder Air suction(optional)



Alignment

- The paperboard sent by feeder shall be corrected by the alignment to ensure go straight.
- The upper pressure drive can be adjusted up and down to adapt to different paperboard thickness.



Prebreaker

- 180° prebreaking of all boxes at high-speed, regardless of material
- Long prebreaker for perfectly flat glue flaps
- Extra wide lower left-hand belt ensures no marking
- High-speed re-opening plough
- Upper left conveyor displacement allows for more flexibility

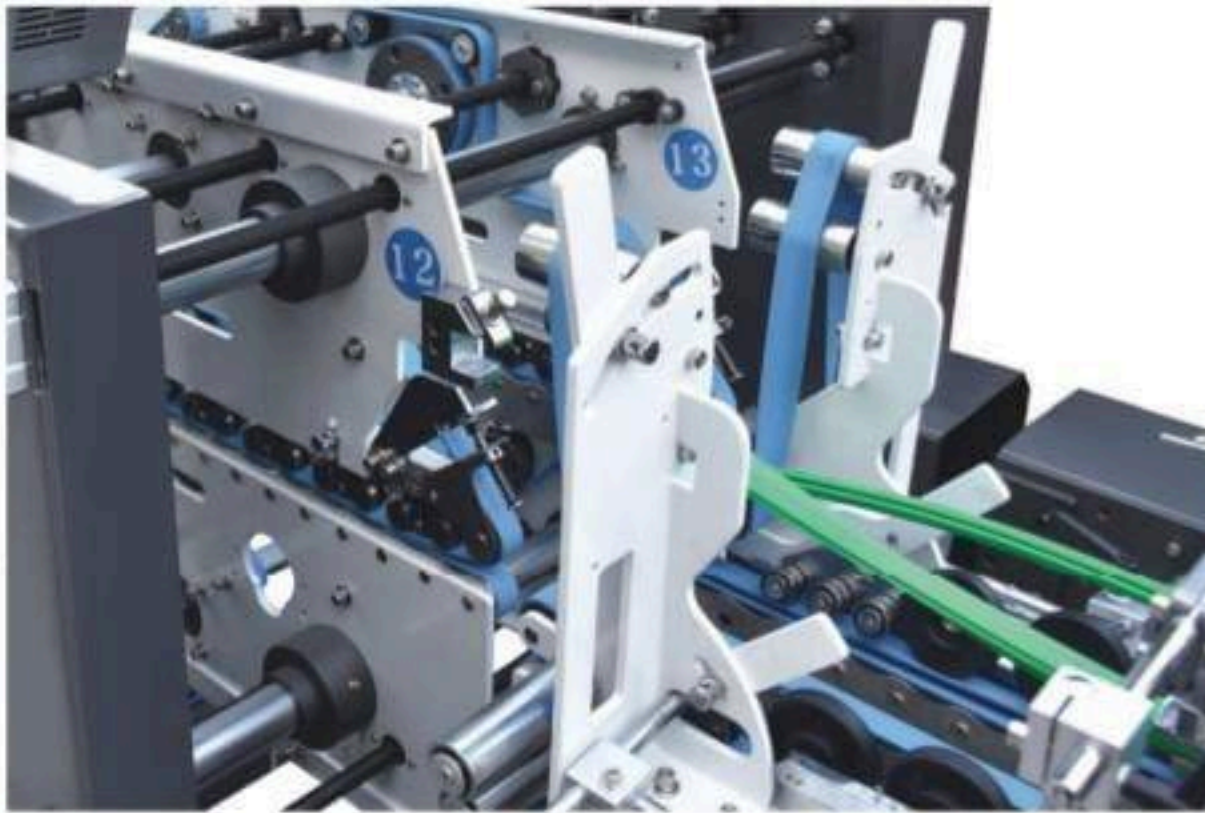

Transfer

- Independent drive for complete control and faster job change
- Synchronized kicker adjusts to carton arrival time
- Adjustable transfer conveyors adapt to difficult box shapes
- Height adjustable for a perfect box stream



Delivery

- Integrated box stream regulator for precise stream intervals and faster running
- In manual mode, the belt moves at a constant speed and is not affected by the main motor speed.
- Pneumatic pressure control is more accurate, to ensure bonding effect.



Crash-lock module

- Processes multiple-fold packaging
- Telescopic upper conveyors easily be adjustable to box format
- Allows for front panel folding



4 & 6-corner device(Optional)

- Fast set-up of all types, and most sizes, of 4 and 6-cornered boxes
- Speeds of up to 22,000 b/h
- Tilting frame adjusts to flap size
- Cable guides for 45° panel
- Modulated hook trajectory for high-speed, high-quality production
- Gluing guns are required for 4/6 corner boxes, minimum 3 guns are used for 6 corner boxes

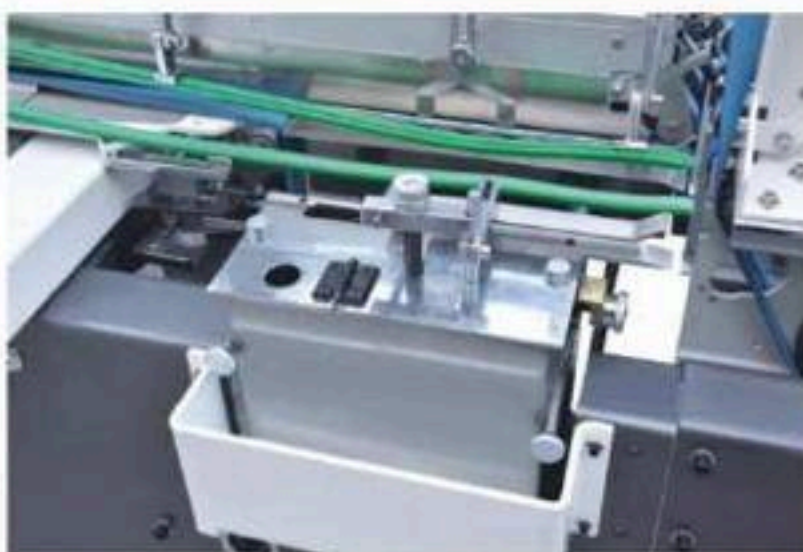

Lower gluing unit

- Oversized stainless steel glue wheel for high-speed running
- Unique scraper device with micro-metric adjustment for precise gluing
- All components easily removable for quick cleaning



Folding

- Minimum folding device for folding down to 35 mm
- Choice of left, right or simultaneous folding
- Automatic belt tensioning ensures quicker makeready
- The left and right folding belt speed can be adjusted independently